

Please read this manual carefully before using the Cambo CSMFC-2!

CAUTION

! Please be cautious when using the CSMFC-2 follow focus on lenses with a stiff/rigid turning focus ring. In this particular case excessive force on the focus knob could lead to damaging the internal gear drive of the CSMFC-2 unit.

Don't tighten the CSMFC-2 clamp when there is no iris rod inserted, this may irreversibly deform the clamp.

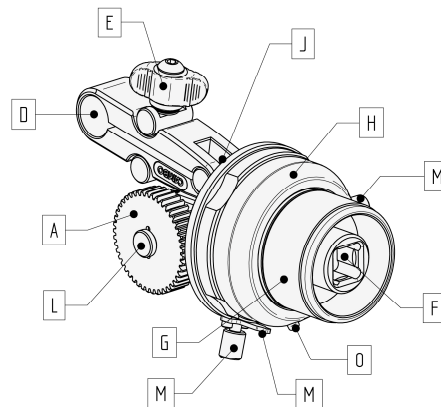
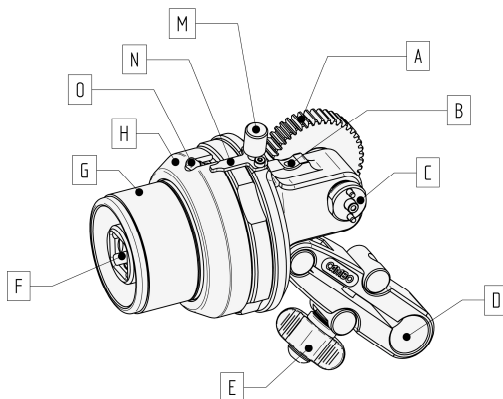

- | | | | |
|---|--|---|--|
| A | Focus Gear M0.8 45 teeth (standard) | H | Marking scale (cut-out version) |
| B | Mounting hole clamp arm | J | Hex bold (metric 3mm) to fix the clamp arm |
| C | Gear flange (on either side of the unit) | K | Focus housing |
| D | Clamp arm (for use with 15mm iris rods) | L | Gear lock |
| E | Clamp knob | M | Knob of the hard-stop |
| F | Accessory mount (star knob/speed crank/whip) | N | Hard stop indicator |
| G | Focus knob | O | Blocking switch |

Changing the focus gear

To change the focus gear **(A)** please unscrew the "gear lock" **(L)** counter clockwise. When the gear lock is loosened the gear can slide off the gear flange **(C)**. The focus gear can be positioned left or right side of the housing.

When using the CSMFC-2 on lenses with the focus ring near to the camera body, its advisable to use the gear on the side closed to the camera.

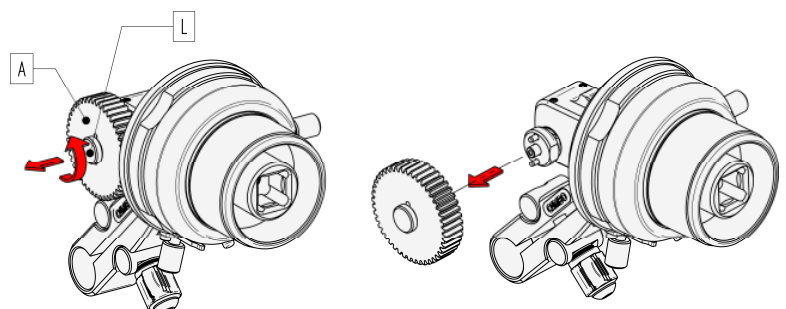

Changing marking scale

The scale **(H)** uses magnetic fixation. To take off the scale, please grasp both sides and pull off the scale. When placing the scale slide the it over the focus knob, align the scale until is snaps into place.

It's advised to use a pencil or standard fineliner for setting the marks. Don't use permanent marking pens for setting the marks.

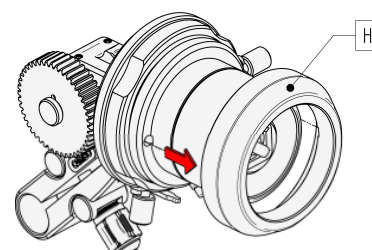

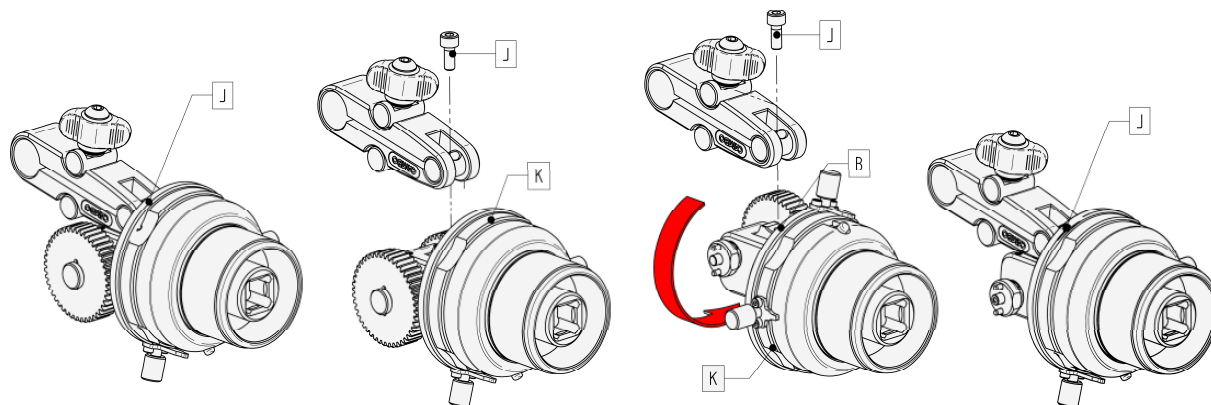

Changing the rotation direction *(note: CW = clockwise and CCW = counter clockwise)*

Not all lenses use the same focus direction, for instance Canon lenses focus the opposite direction as Nikon. You can change the direction by flipping the focus housing (**K**) in relation to the clamp arm (**D**). Please unscrew bolt (**J**), flip the focus housing (**K**) and reattach bolt (**J**) in the mounting hole of the clamp arm (**B**).

The images below indicate the direction in relation to the position of the focus housing (**K**).

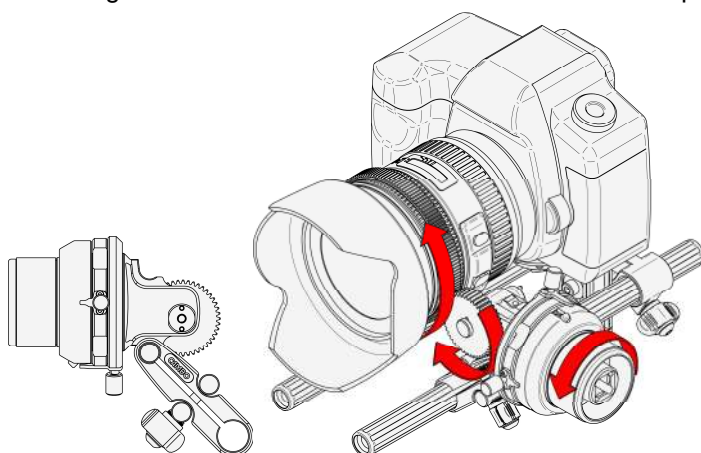

Focus-knob CCW > Focus-ring CCW

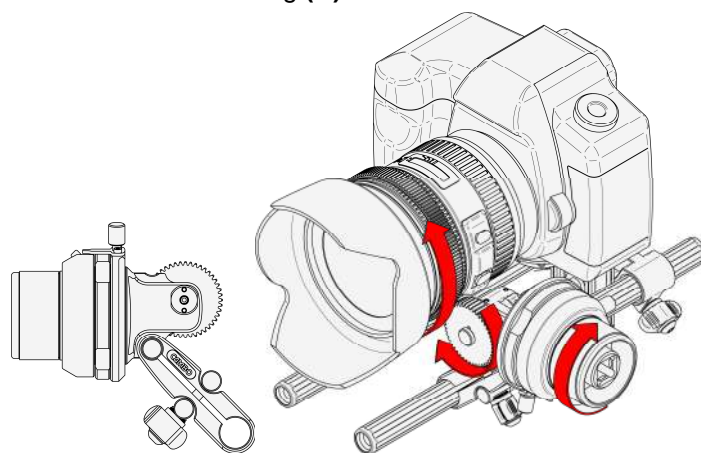

Focus-knob CW > Focus-ring CCW

Hard-stop and switch

To change the position of the hard-stops (**N**) please unlock knob (**M**), set the hard-stop to the desired position and lock (**M**). If you want to make a full turn of the focus knob, please unlock switch (**O**), the image to the right shows the switch in the locked and unlocked position.

Change the angle of the focus unit

The focus housing (**K**) can be set to different angles, as shown in the image above. Please unscrew the clamp knob (**E**) and tilt the focus housing up or down to the desired angle. Ensure that the focus-gear is pressed gently to the lens-gear and tighten clamp knob (**E**).

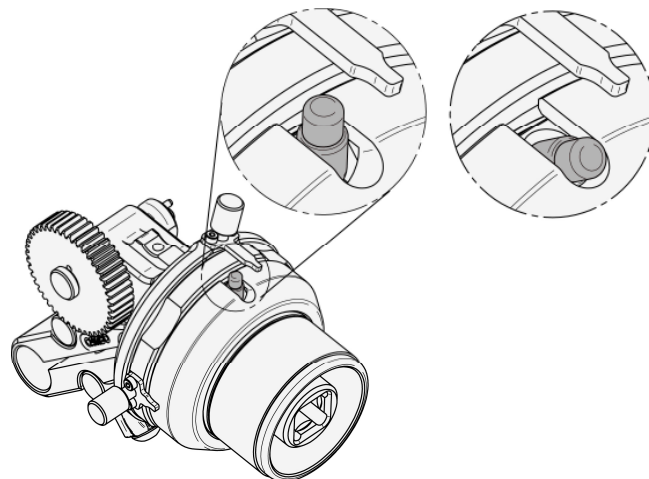

Change lenses

If you want to change a lens, please loosen clamp knob (**E**), tilt away the focus unit and tighten the clamp knob again. There is now room for changing the lens. After changing the lens please loosen the clamp knob, set the focus unit to the desired angle and gently press the focus-gear to the lens strip and finally tighten the clamp knob.